

DFO Homebush

3-5 Underwood Road, Homebush NSW 2140

Telephone +61 2 9748 9800

dfo.com.au/homebush

DFO Homebush is a two-level retail outlet centre located approximately 12kms west of Sydney's CBD. The centre comprises more than 110 luxury, international and local outlet retailers including Armani Outlet, Bose, Burberry, Coach, Escada, Furla, Max Mara, Michael Kors, Polo Ralph Lauren and Salvatore Ferragamo. The centre also comprises a Homemaker Hub with more than 15 large format stores. DFO Homebush is Sydney's leading fashion outlet destination offering discerning customers and tourists looking for high-end fashion brands and homewares a compelling and convenient offer.



Centre statistics

Centre type	Outlet Centre
Annual traffic (million)	3
Total GLA (sqm)	29,882
Total tenants	127
Majors ¹	-
Mini Majors ²	Adairs, Bed Bath N Table, Focus On Furniture And Bedding, Freedom, JB Hi-Fi Home, Just Sport, Oz Design Furniture, Polo Ralph Lauren, Provincial Home Living, Puma, Sheridan, Sleepys, Snooze, Woodbury House Furniture
Number of specialty retailers ³	110
Number of car spaces	2,020
Moving annual turnover (MAT) (\$m) ⁴	318.1
MAT/sqm – Total (\$)	10,547
MAT/sqm – Specialty (\$) ⁵	14,641

Centre statistics correct as at 30 June 2018

1 Classified in accordance with SCCA guidelines, typically includes supermarkets, department stores and discount department stores. Also includes Cinemas

2 Stores >400 sqm, by Sales Group

3 All sales reporting tenants under 400sqm, but excludes travel agents and lotto and free standing pads sites

4 Total MAT includes all reporting tenancies and is inclusive of GST, as at 30 June 2018

5 MAT/sqm - Based on sales and area for all reporting tenants, non-retail tenants excluded, as at 30 June 2018

Key statistics

2,923,503

Residents in TTA

\$93,620

Average household income

14

Mini major retailers

Source: Produced by Vicinity Data Science & Insights. This material is a derivative of ABS Data that can be accessed from the website of the Australian Bureau of Statistics at www.abs.gov.au. TTA: Total Trade Area

LEVEL 1

HOMEBUSH BAY DRIVE

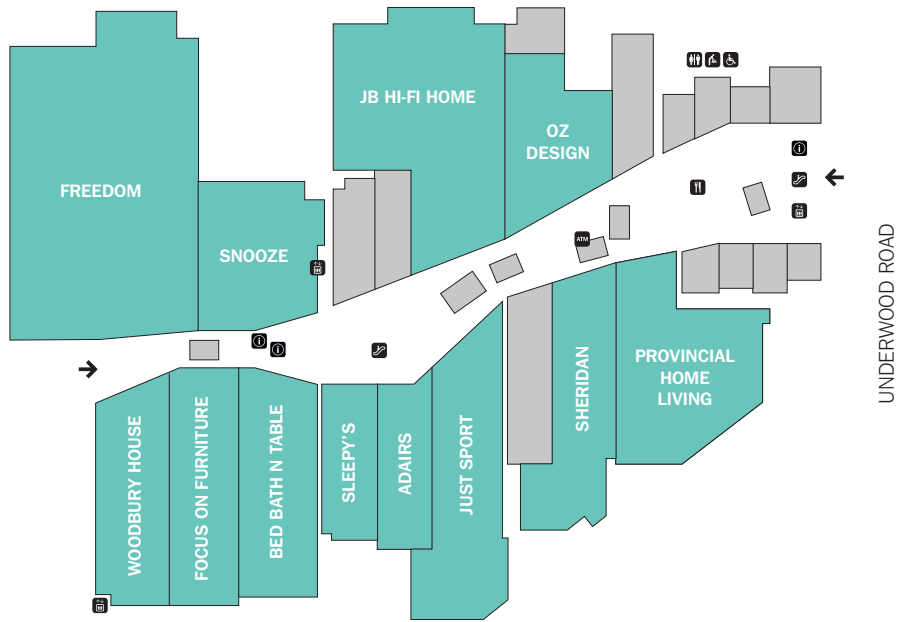

LEVEL 2

HOMEBUSH BAY DRIVE



- MAJORS
- MINI MAJORS
- SPECIALTIES
- ENTRANCES →

Floor plan as at 30 June 2018.

For further information please contact:

Vicinity Centres

Level 4, Chadstone Tower One, 1341 Dandenong Road , Melbourne VIC 3148
Telephone +61 3 7001 4000, Facsimile +61 3 7001 4001

Disclaimer
Information contained in this document is based on historical data and is illustrative only. It does not provide any predictions as to future events or outcomes and does not constitute a lease offer or warranty as to the profitability, design or layout of the centre. You should carry out your own investigations and satisfy yourself in that regard and obtain independent legal, financial and business advice before making any decision or entering into any agreement or arrangement concerning the subject matter of this document or the centre. The information is provided on the clear understanding that while care has been taken in its preparation, to the extent permitted by law, all liability for omissions or errors however arising is expressly disclaimed. Vicinity Centres may amend, add or remove any information in this document at any time without further notice to you. You may not copy or use any part of this document without the express written consent of Vicinity Centres. Any monetary amounts are expressed in Australian dollars unless otherwise stated. Rates are subject to change without notification.