



Chatswood Chase Sydney

345 Victoria Avenue, Chatswood NSW 2067
chatswoodchasesydney.com.au



Chatswood Chase Sydney is a four level Major Regional shopping centre located approximately 10 kilometres north of the Sydney CBD. It is anchored by David Jones, Kmart and Coles and includes more than 165 specialty stores. Chatswood Chase Sydney features iconic international and Australian designer brands such as Apple, Hugo Boss, Ralph Lauren, Max and Co, Furla, Coach, Zimmerman, Mecca Cosmetica, Nespresso, Williams-Sonoma, West Elm and Pottery Barn.

Property overview

State	NSW
Centre type	Major Regional
Ownership Interest (%)	100
Date acquired*	2003
Centre first opened	1980
Latest redevelopment	2009
Valuation External/Internal	Internal
Valuation (\$m) ¹	1,121.2
Valuation date	Dec-17
Capitalisation rate (%)	4.75
Discount rate (%)	7.00

Property metrics

GLA (sqm)	63,815
Number of tenants	204
Major tenants ²	Coles, David Jones, Kmart
Car spaces	2,441
Moving annual turnover (MAT) (\$m)	556.8
MAT/sqm – Total (\$)	9,939
MAT/sqm – Specialty (\$)	14,012
Specialty occupancy cost (%) ³	15.5
Occupancy rate by GLA (%)	99.6
Weighted average lease expiry by GLA (years)	5.6
Green Star – Performance	3 Stars
NABERS Energy rating	3.5 Stars
NABERS Water rating	1.0 Star

* 50% acquired in 2003 and remaining 50% acquired in 2007.
¹ Expressed on 100% basis.
² Classified in accordance with SCCA guidelines, typically includes department stores, discount department stores and supermarkets.
³ Includes marketing levy and based on GST inclusive turnover.
⁴ Includes holdovers.

Tenant mix by gross lettable area (GLA)

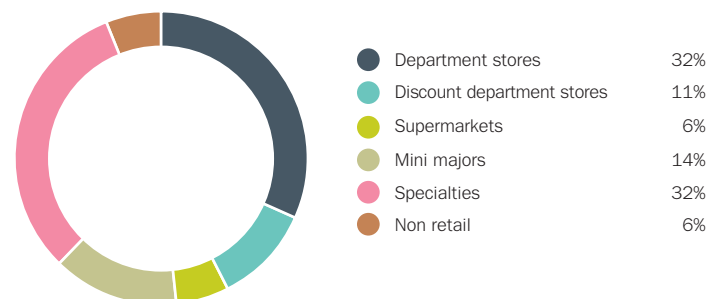

Specialty store lease expiry profile by income

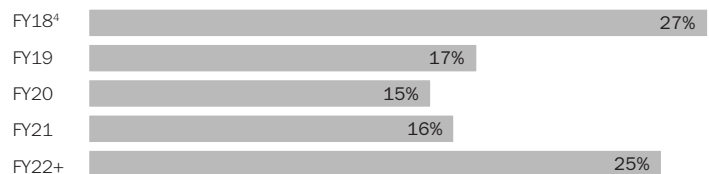

GROUND LEVEL

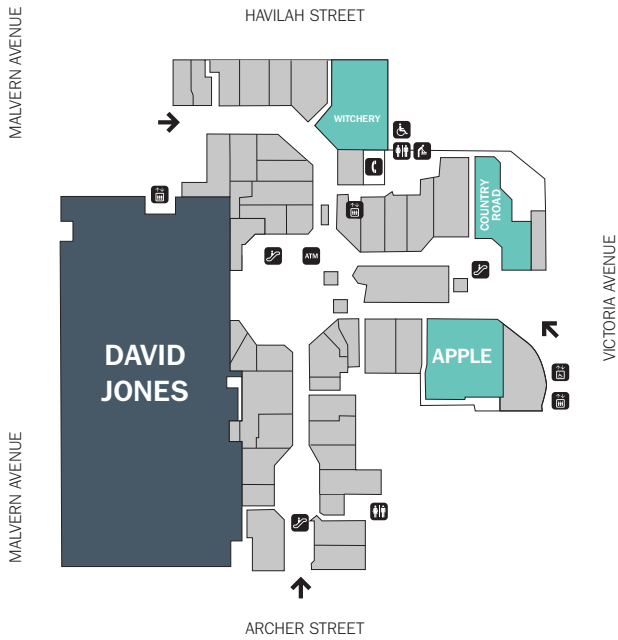

LEVEL TWO

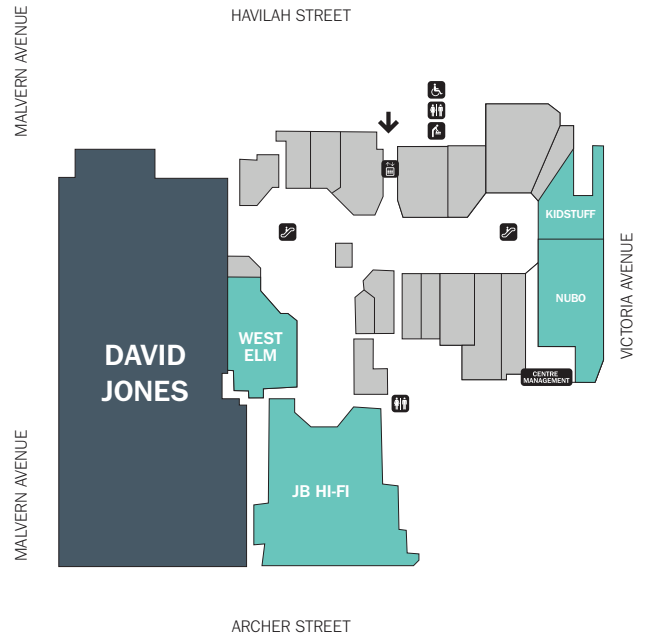

LOWER GROUND LEVEL

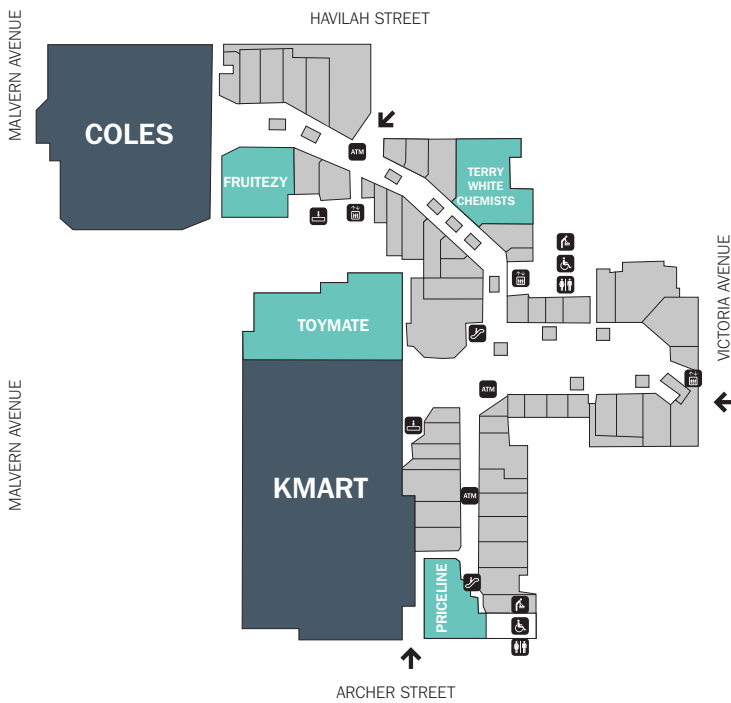

LEVEL ONE

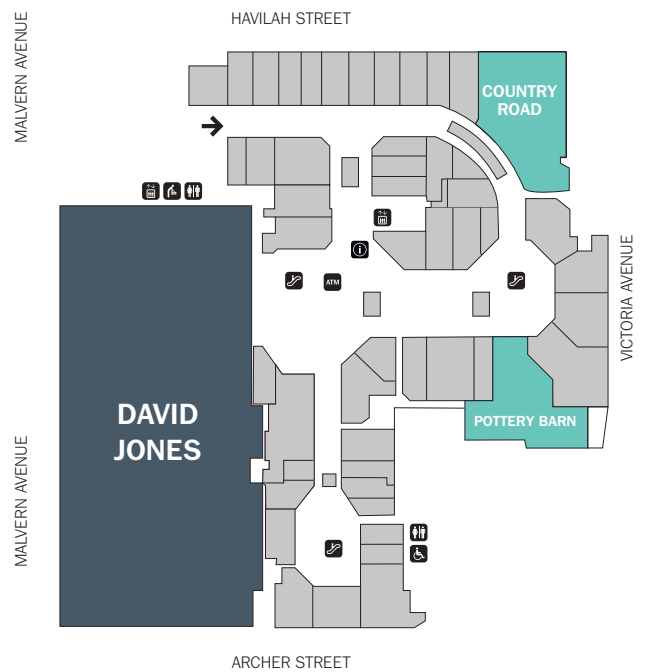

- MAJORS
- MINI MAJORS
- SPECIALTIES
- ENTRANCES →